

# BackPack II

Li-Ion battery pack BP2

11.1V 2200mAh

User guide

ruarkaudio

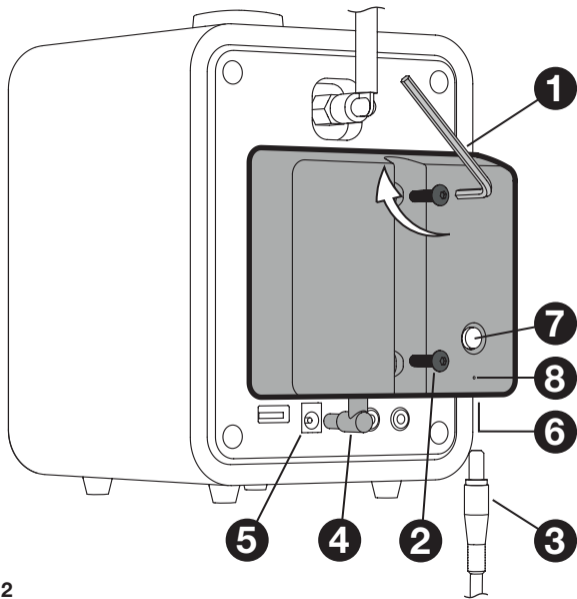

EN-2

## What's in the box?

BackPack II, Allen key (1),  
2 x M4 fixing screws (2).

*Please retain all packaging.*

## Fit your BackPack II

Unplug the mains adapter (3)  
from your Ruark radio or speaker.

Place your BackPack II on the  
back of your radio or speaker and  
push the DC output connector  
(4) into the 14V DC socket (5).

Secure your BackPack II with  
the two screws provided (2)  
using the allen key (1), taking  
care not to overtighten them.

Connect the mains adapter (3)  
to the DC input socket (6) on the  
underside of your BackPack II.

## Switch on your BackPack II

Press the power button (7)  
to the ON position.



*To turn on your R1 mk3  
radio when it is powered  
by battery alone, you need  
to press and hold the standby key  
for a few seconds until the logo  
appears on the display.*

*If leaving your radio or speakers off  
for extended periods of time with the  
BackPack II fitted but not plugged  
into the mains, we recommend you  
switch the power button (7) to OFF.*

## **Using it with an R1 mk4 radio**

You can use the R1 mk4 radio as normal. The only difference is that to save power when powered by battery power alone the screen turns off in standby mode. If using alarms, please ensure the battery has sufficient charge.

## **Using it with an R1 mk3 radio**

To turn the R1 mk3 radio on, press and hold the standby key for a few seconds until the logo appears on the display.

To turn the radio off, press the standby key as normal but please note that to conserve battery life your radio will switch off completely instead

of going into standby.

When powered by battery alone, alarms will not work once the R1 mk3 is switched off. Alarms will work if your BackPack II is left ON but we don't recommend this.

## **Using it with an R1 mk2 radio or MR1 speakers**

When your BackPack II is ON your R1 mk2 or MR1 will behave as if powered by mains adapter so simply press the standby key or knob to turn your radio or speakers on or to standby.

Please note that leaving your R1 mk2 or MR1 in standby when running solely from the battery power will drain the battery quite quickly.

To get the maximum battery life, we recommend your BackPack II is switched OFF when not using your radio or speakers.

## **Charging your BackPack II**

Whenever your BackPack II is connected to power it will charge, indicated by the green light on the back (8). Typically, it will take around 5hrs to fully charge.

## **Specifications**

Model: BP2

Battery type: Li-Ion

Capacity: 2200mAh

Nominal output: 11.1VDC

Charge voltage: 14.0VDC

Approx. charging time: 5hrs

Approx. battery life: 8hrs

## Safety information



### **CONTAINS LITHIUM ION CELLS**

**Never attempt to open the battery pack for any reason. If battery pack case is cracked or damaged, do not fit it to a radio or speaker. Do not crush, drop or damage battery pack. Do not use a battery pack that has been dropped or damaged in any way. Damaged battery packs should be returned to service centre or recycled.**

**Do not incinerate the battery pack even if it is severely damaged or is completely worn out.**

**If battery contents come into contact with the skin, immediately wash area with mild soap and water.**

Read this user guide and follow all instructions, it will help you set up and operate your product properly.

Heed all warnings and keep this user guide for future reference.

Refer all servicing to qualified service personnel.

This device is intended to be operated **ONLY** from the AC voltages listed on the device or included power supply. Operation from voltages other than those indicated may cause irreversible damage to the device and void the product warranty.

Use only the power supply provided with the original Ruark radio or speakers or an approved alternative.

Ensure that the power adapter, mains plug or mains connector into the unit is readily accessible in case disconnection from the mains is required.

The mains adapter, mains plug or mains connector must be removed from the socket to completely disconnect the system from mains power.

Do not place any naked flame sources, such as lighted candles, on or near the device. Do not install near any heat sources such as radiators, stoves, or other devices (including amplifiers) that produce heat.

Avoid exposure to extreme heat or cold.

Only use attachments/accessories specified for this device. Make no modifications to the system or accessories. Unauthorised alterations may compromise safety, regulatory compliance, and system performance.

To reduce the risk of fire or electrical shock, do not expose the device to rain or moisture. Do not expose this device to dripping or splashing, and do not place objects filled with liquids, such as vases, on or near the device. As with any electronic products, use care not to spill liquids into any part of the system. Liquids can cause a failure and/or a fire hazard.

Always leave a space of at least 10cm around the device for ventilation and ensure that curtains or other objects never cover ventilation openings on the device.

## Regulatory information



This device is labelled in accordance with European Directive 2002/96/EC concerning waste electrical and electronic equipment. This symbol indicates that the product or associated batteries should not be disposed of as general household waste. As with any electrical equipment, please dispose of it according to local regulations.



### CE COMPLIANCE INFORMATION

This product conforms to all EU Directive requirements as applicable by law. You may obtain a free copy of the Declaration of Conformity by contacting your dealer, distributor, or Ruark Audio. Hereby, Ruark Audio, declares that this BackPack II is in compliance with the essential requirements and other relevant provisions of Directive 1999/5/EC.

## Guarantee information

We guarantee this product to be free from defects for a period of two years from date of purchase, providing due care and attention has been paid. Product failure through accidental damage (however caused), excessive wear and tear, negligence or unauthorised modification will void your guarantee.

Should you experience a problem please contact us via our website [www.ruarkaudio.com](http://www.ruarkaudio.com). If your product needs to be returned it should be packaged in its original packing along with proof of purchase. If it is not possible to return the product by hand, then it should be sent carriage prepaid by a reputable parcel carrier. If the original packing is not available, replacement packing can be purchased from us.

## Guarantee for overseas sales

The distributor in the country of purchase guarantees products purchased outside the UK. For details, please contact your local Ruark distributor or outlet.

**THIS GUARANTEE IN NO WAY VARIES OR REMOVES THE PURCHASER'S STATUTORY RIGHTS. E&OE**

# ruarkaudio

59 Tailors Court, Temple Farm Industrial Estate,  
Southend on Sea, SS2 5TH, UK  
[www.ruarkaudio.com](http://www.ruarkaudio.com)

Designed in  
Great Britain



20200626.1